



Wide, Hard, and Long Scale Model Series

1/72&1/48&1/32 scale Handley Page HP42W kit

2 January, 2023 Edition

Size dimension in this instruction is “millimeters” .

Designed by Toshihiko Shimizu

3D printed in Japan

ABS filament and resin for 3D printers Made in China

1 The kit inbox

Wing and fuselage

(inside and outside burr should be removed carefully before painting or assembling)

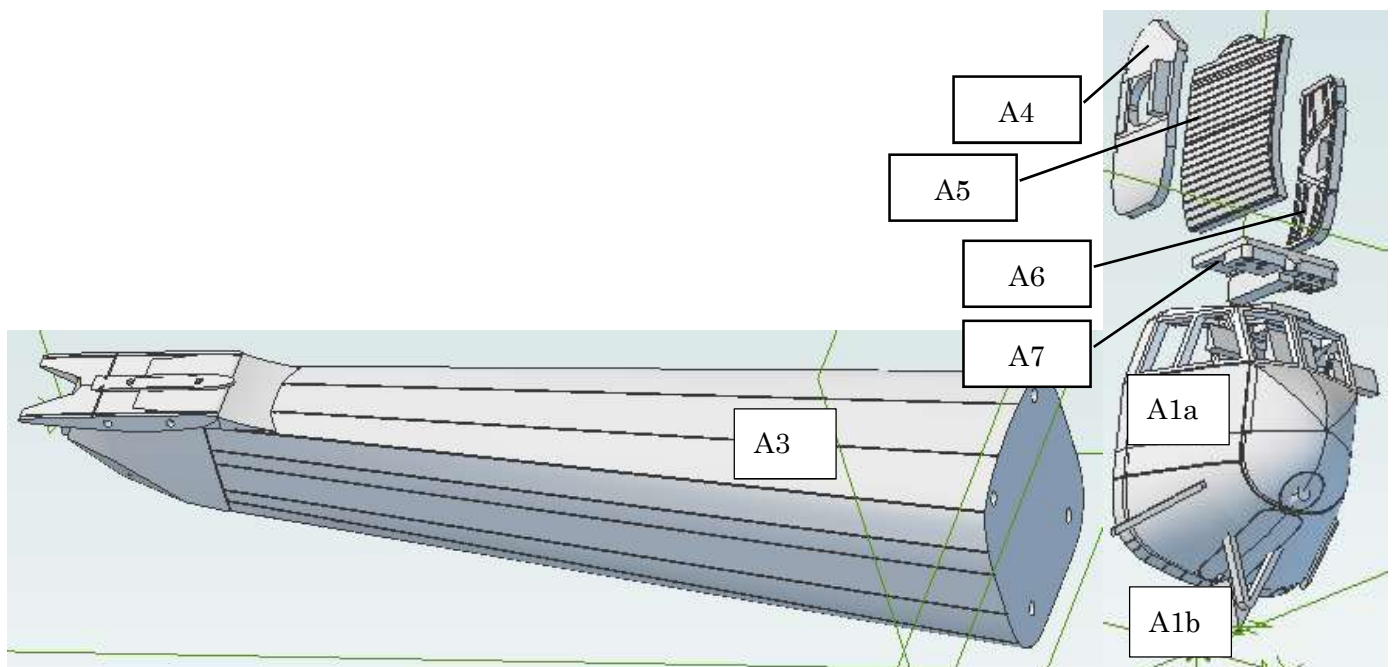

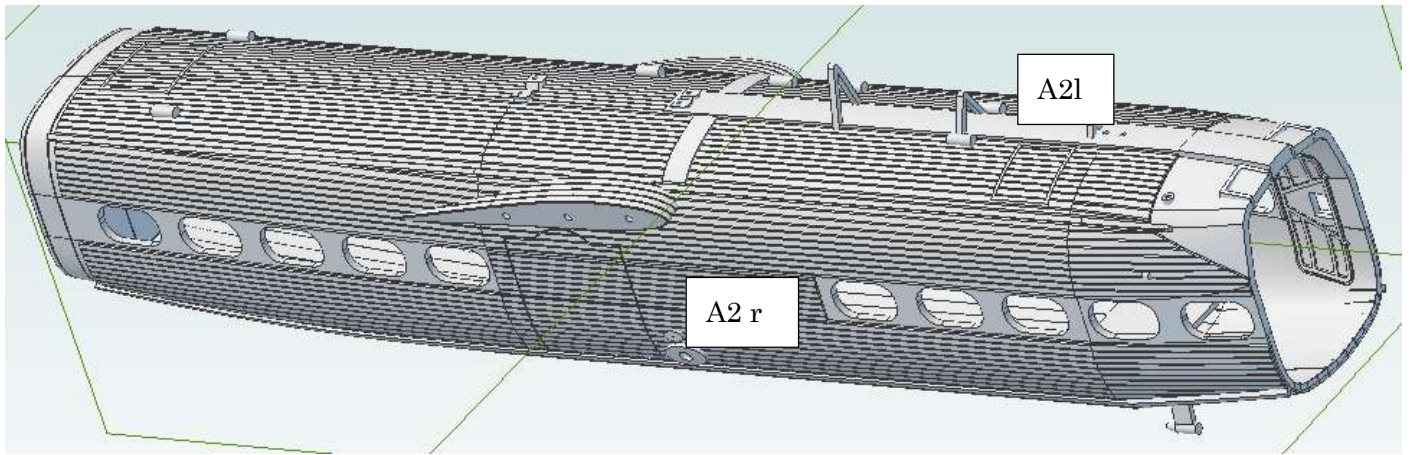

B1r
Opposite: B1l

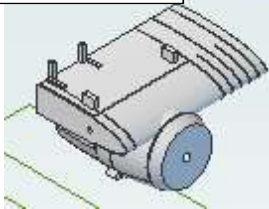

B2r
Opposite: B2l

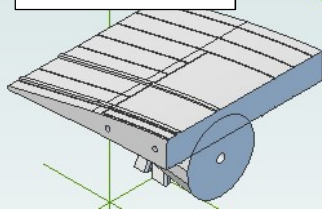

B3r
Opposite: B3l

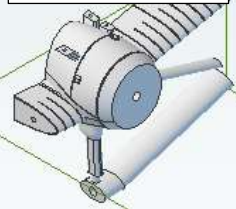

B4r
Opposite: B4l

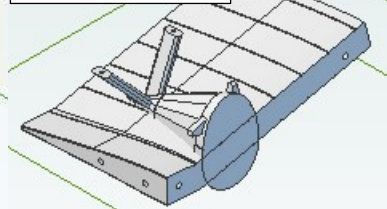

B5r
Opposite: B5l

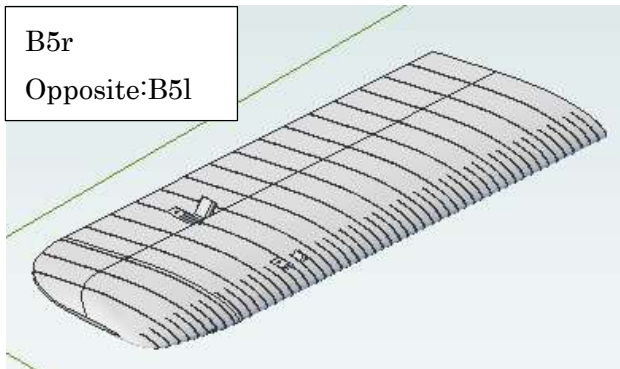

B6r
Opposite: B6l

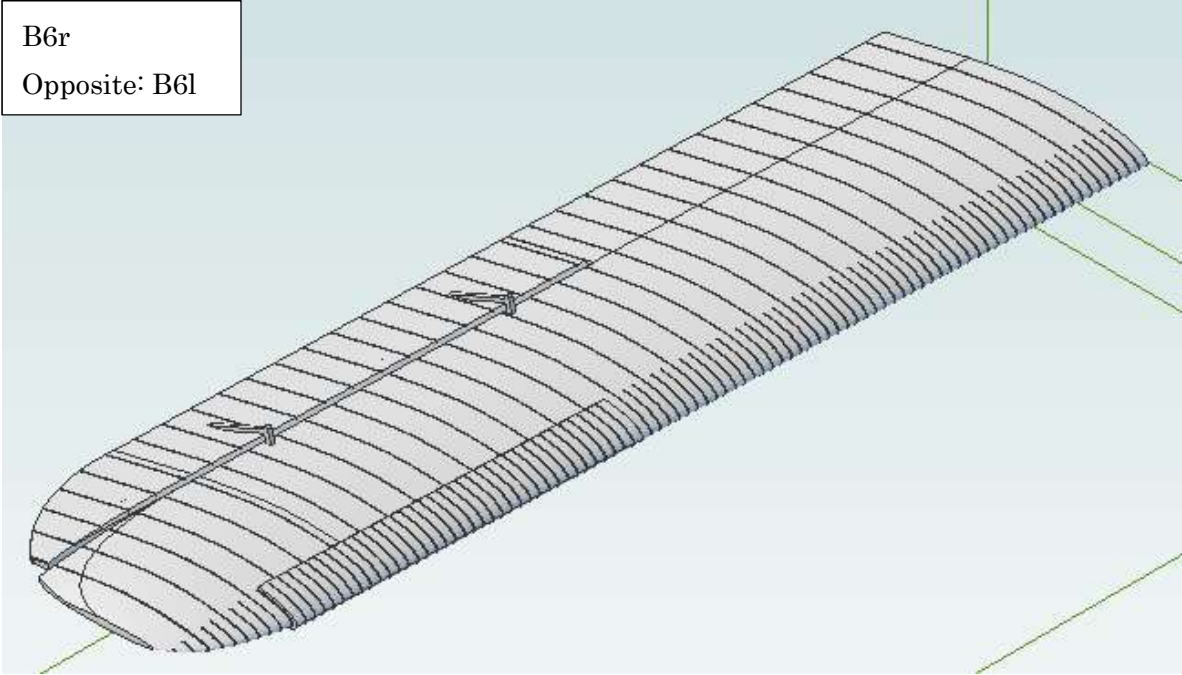

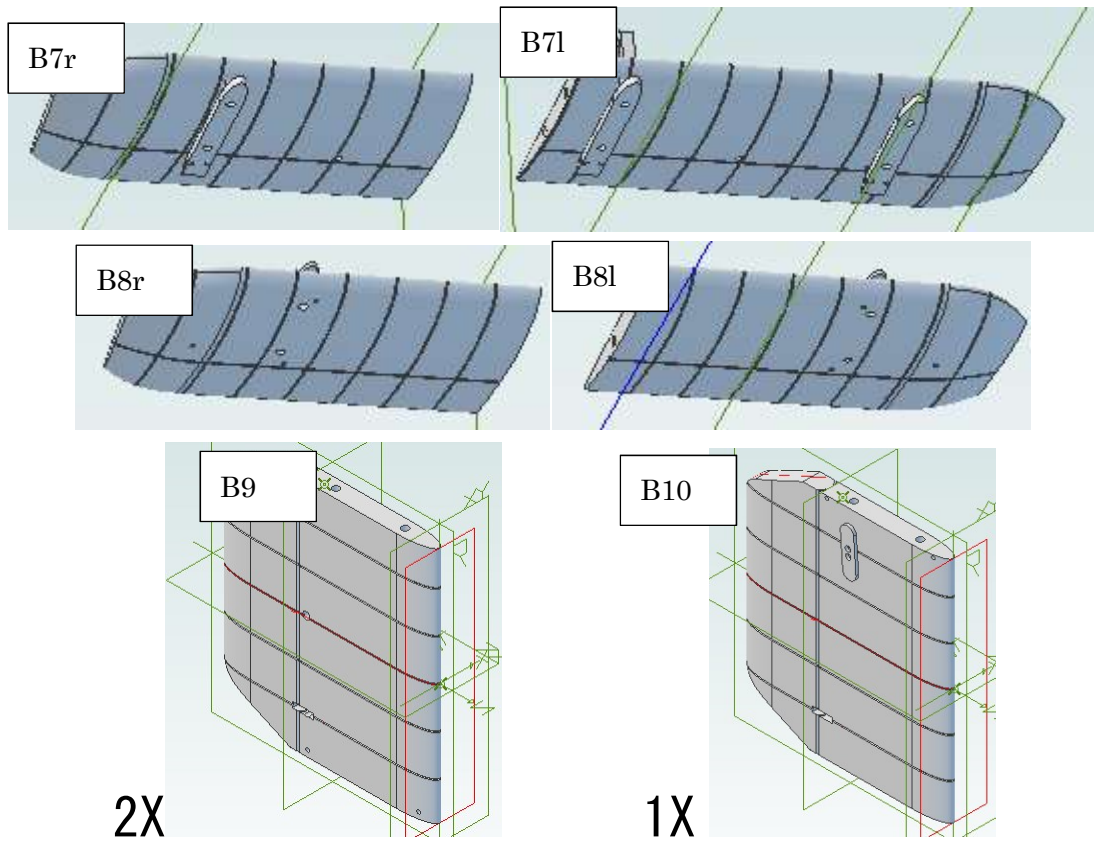

Interior and exterior accessories

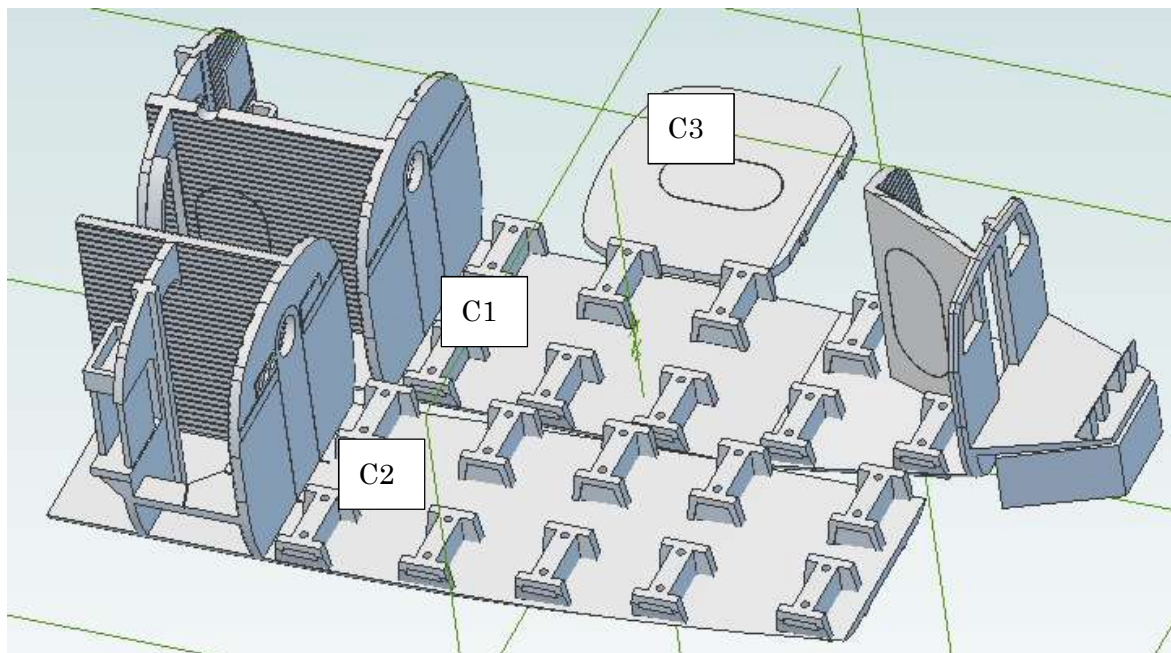

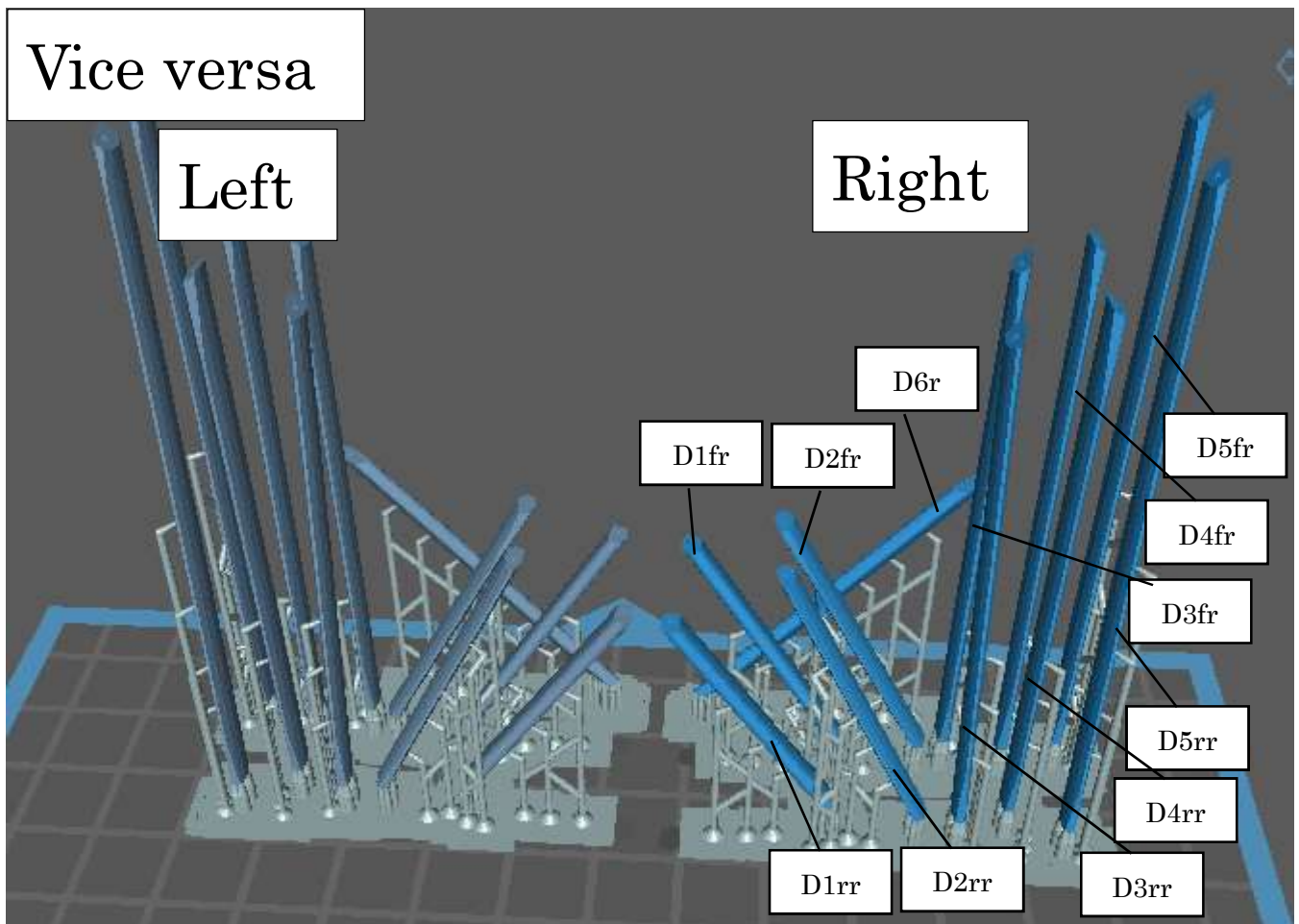
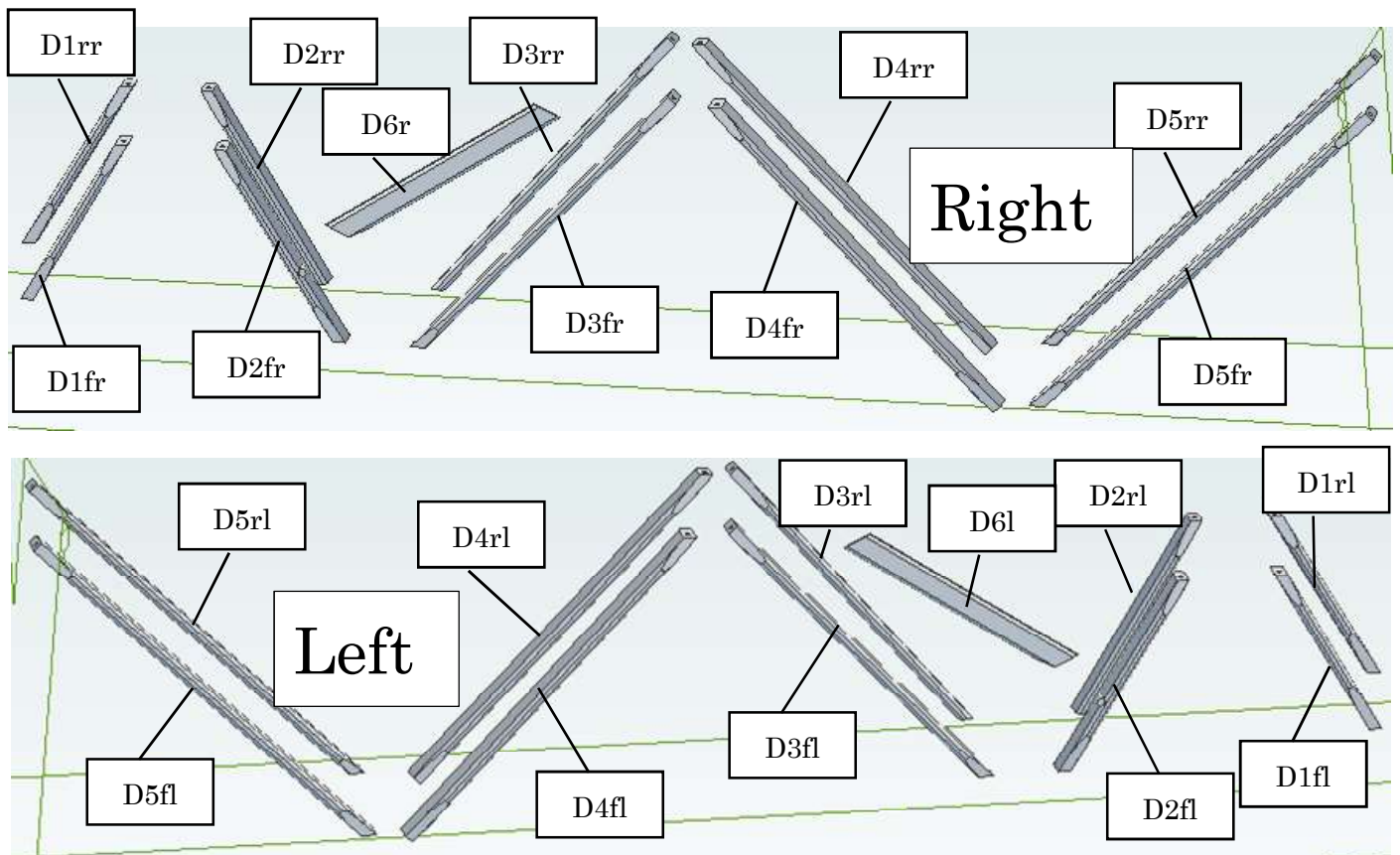

From SN150, struts are made of resin.

Partial sanding is necessary after removing supportive material even if resin parts!!

Example: Opposite K1R is K1L.

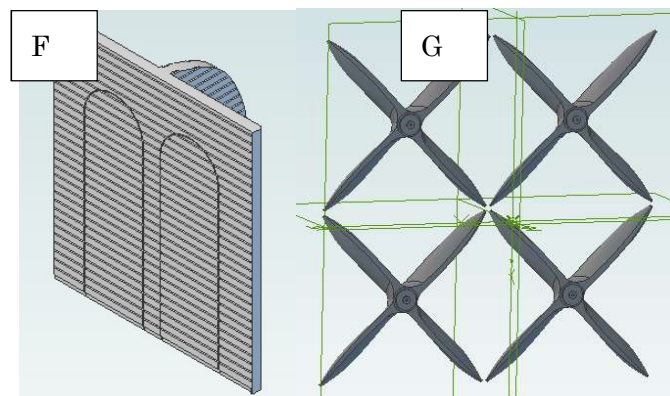
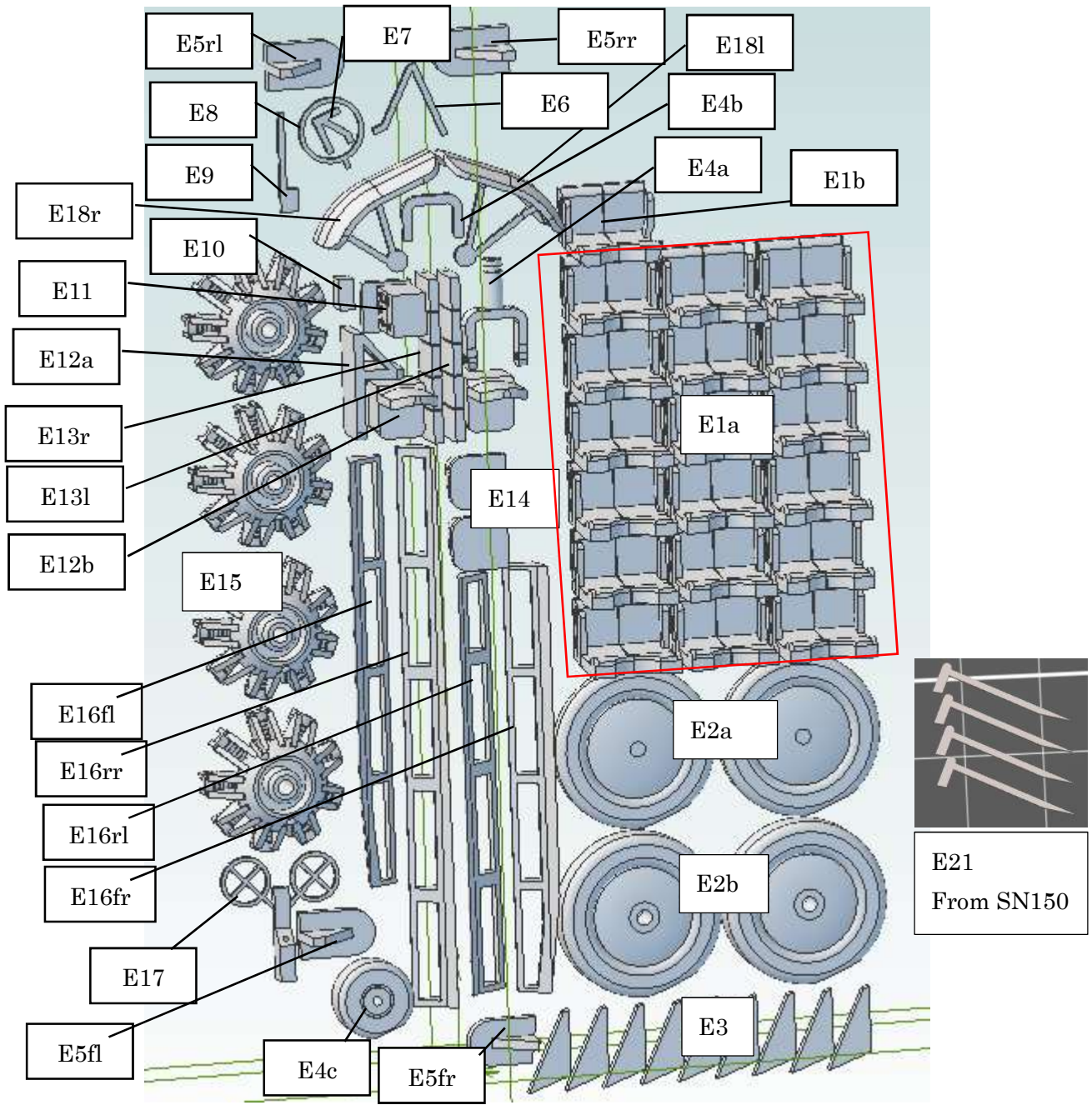

From SN150, E15 and G are made of resin.

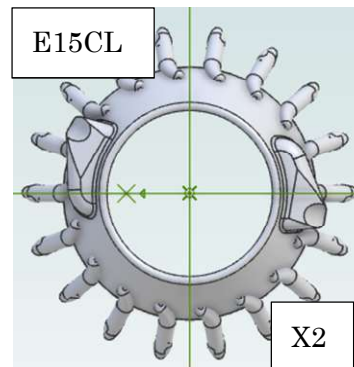
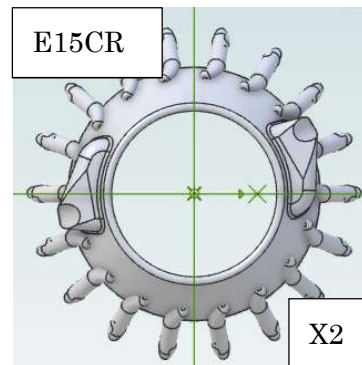

Resin engine parts E15 (From SN150)

Partial sanding is necessary after removing supportive material even if resin parts!!

Sticker blue

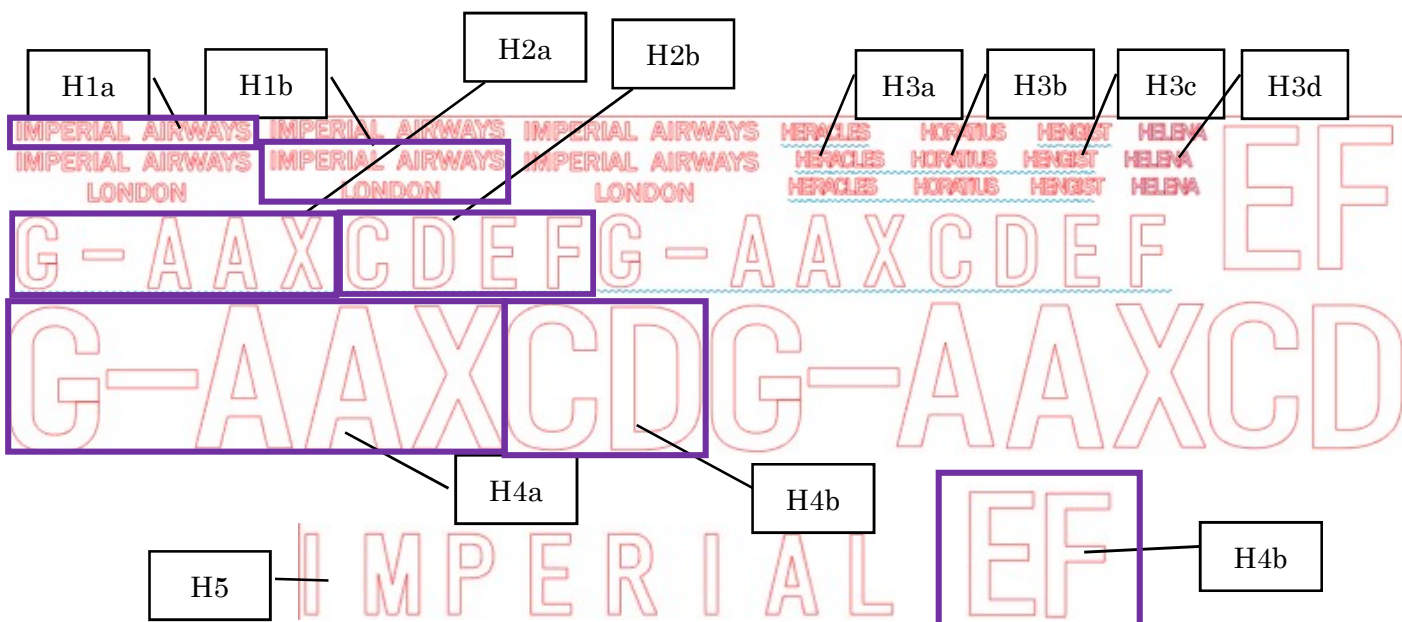

Sticker black



Sticker white



Sticker silver

Before SN150

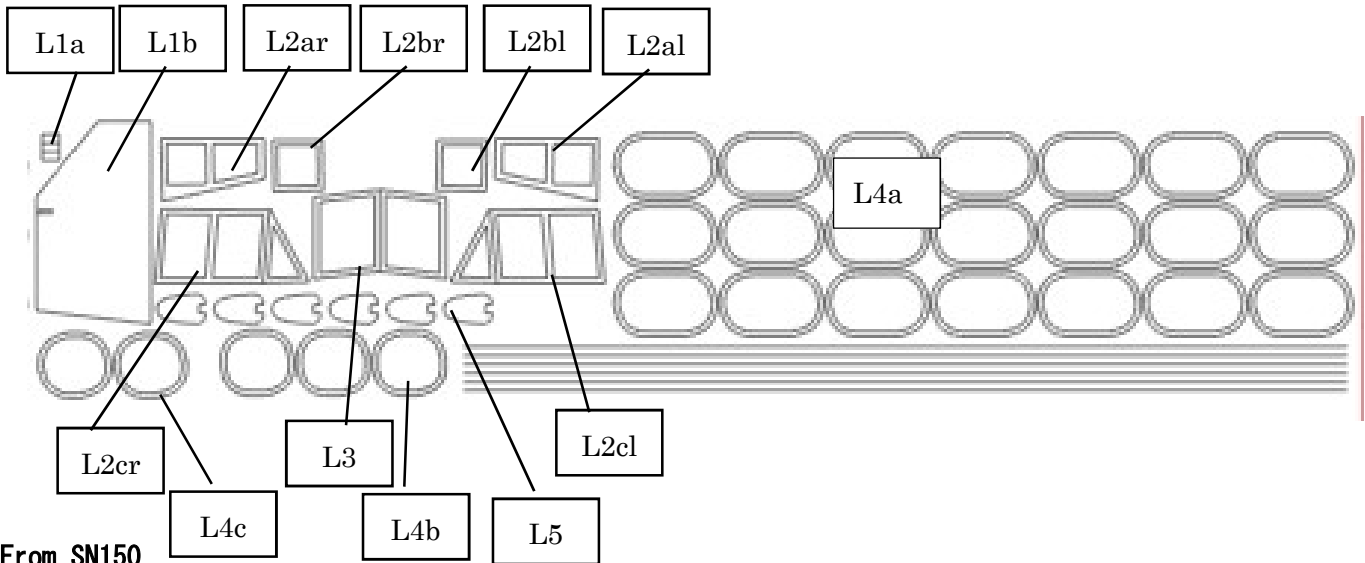

From SN150

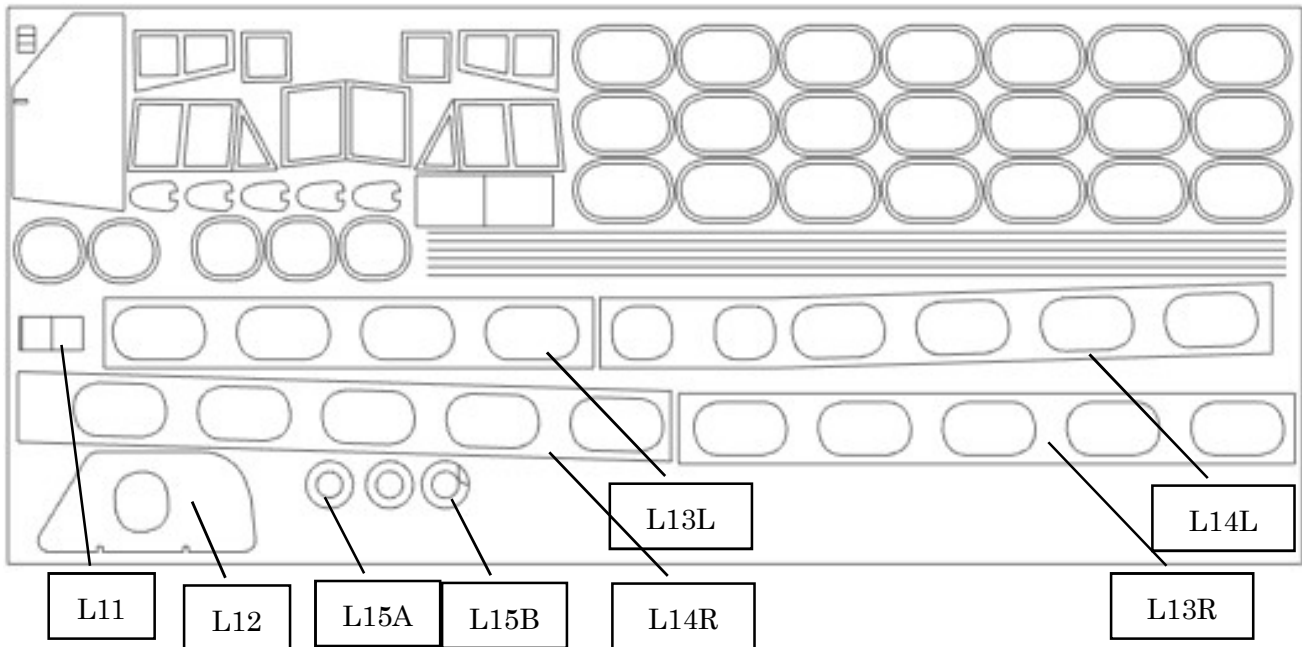

Clear tape for passenger window

Before SN150

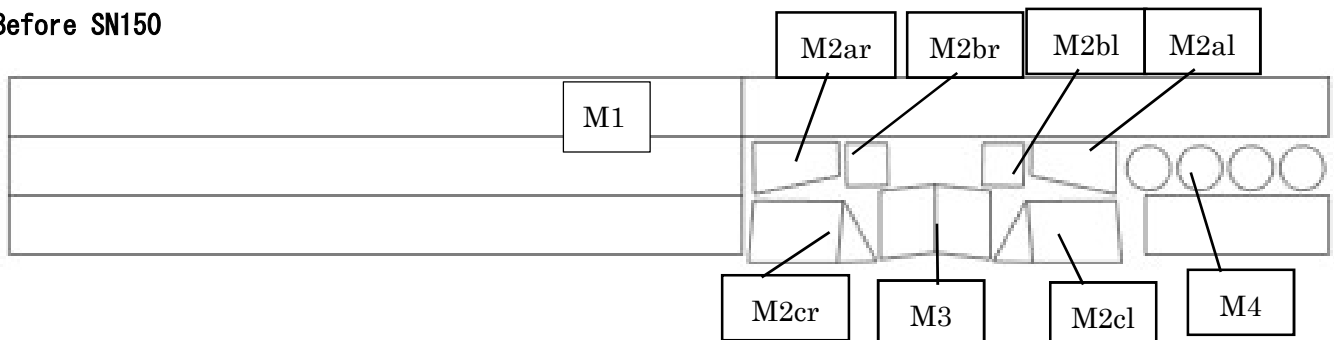

From SN150

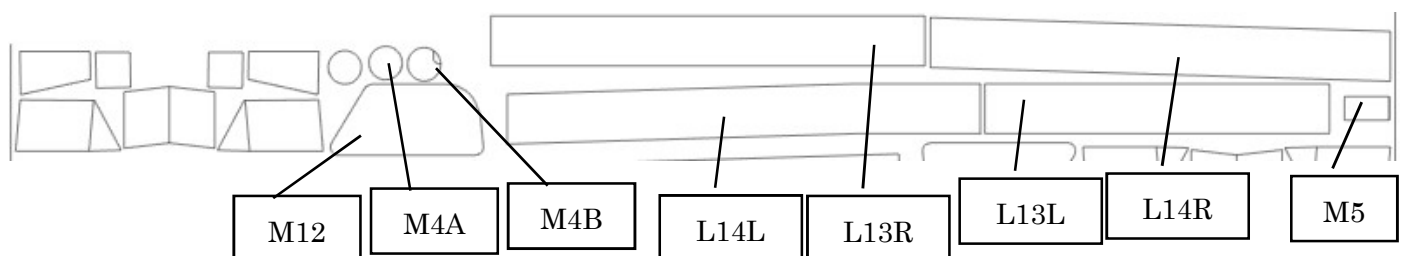

Window (0.1mm thickness poly styrene clear sheet)

Masked by masking tape, which is useful for painting.

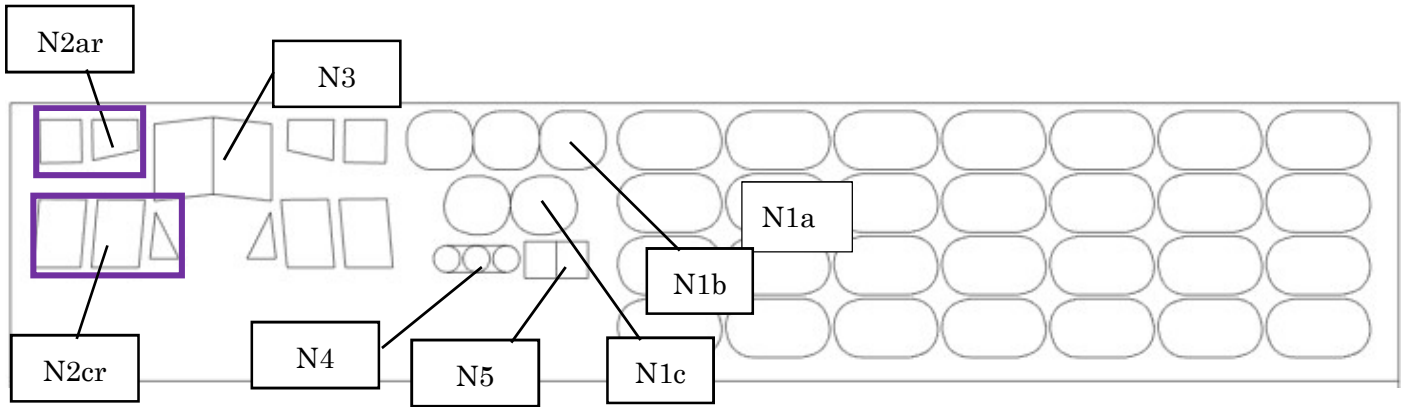

Net for baggage rack

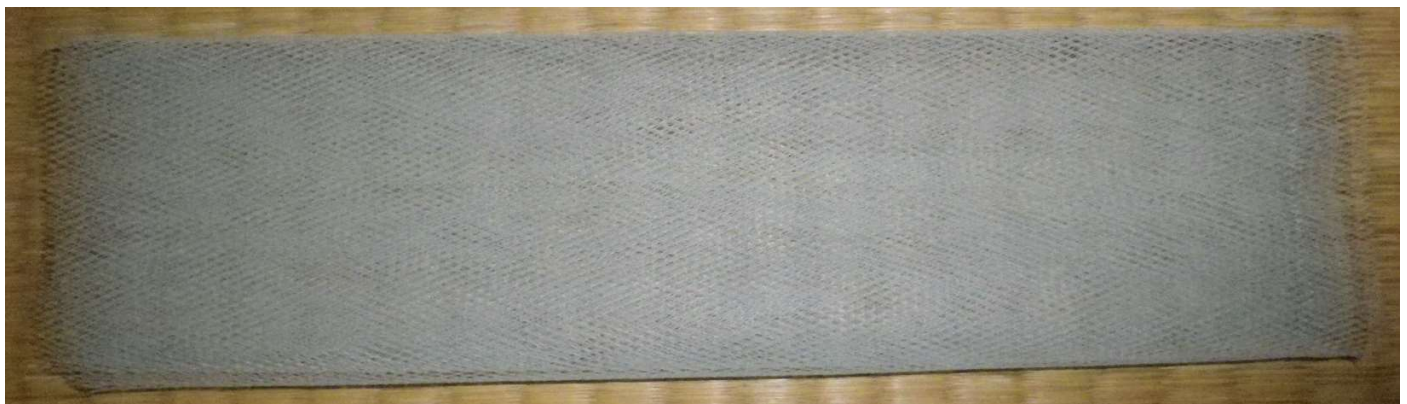

Rod parts

1/72: ϕ 1.8mm bamboo, ϕ 0.5mm ϕ 0.8mm brass rod, ϕ 1.0mm PS rod, ϕ 1.2mm brass wire

1/48: ϕ 3.0mm bamboo, ϕ 0.8mm ϕ 1.2mm brass rod, ϕ 1.0mm PS rod, ϕ 1.8mm aluminium wire



Sand paper set and PS plate

